

Maxim 3D flag hinge – Fitting instructions

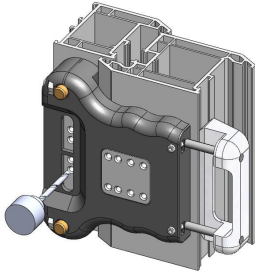

- 1.** Position jig over centred sash and frame.
Pre drill 4mm diameter
12 places.



- 2.** Fit 'mounting block' to frame and secure with two Ø4.8x45mm screws provided.

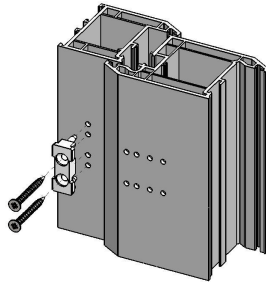

- 3.** Locate 'hinge assembly' on to the 'mounting block' and slide down to retain. (Hinge should slide approximately 14mm to fully engage).

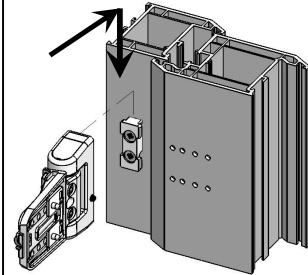

- 4.** Rotate the 'hinge flag' and engage pegs in pre drilled holes.
Secure with two Ø4.8x29mm and four Ø4.8x45mm screws provided.

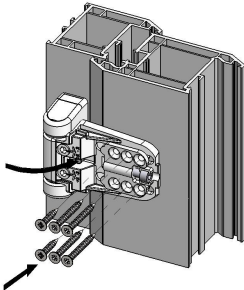

- 5.** Open the door sash and engage to anti lift off screw using a 2mm allen key.
Note:
Screw to be fully engaged then turned back ½ turn.

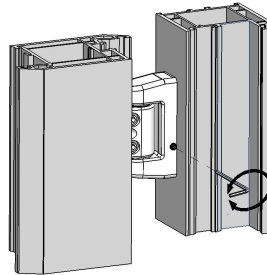

- 6.** Adjust sash as required using a 5mm allen key.

Vertical Adjustment:
+4mm / -1mm

Horizontal Adjustment:
+5mm / -5mm

Compression Adj:
+2mm / -2mm

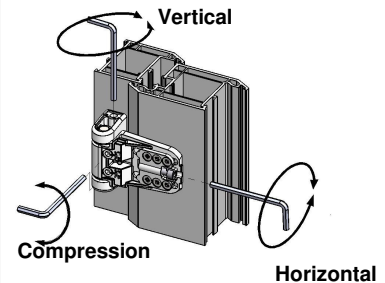

- 7.** Fit cover and retain with posi-drive screw supplied.
Note:
Screw access only possible with the door sash in the open position.

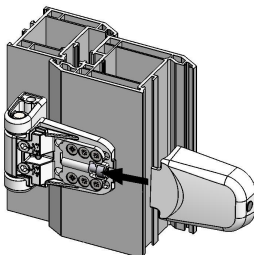

IMPORTANT NOTE:
Gasket compression adjustment is only possible with the cover removed.
Both compression adjusters should be turned sequentially up to a maximum of 45° per sequence (or until the adjuster becomes tight).
Forcing of the compression adjuster may cause damage to the hinge.

